

# MEGALINEAR

## T5 OPEN-ENDED

STANDARD WIDTHS (mm)	6	10	16	25	32	50	75	100	150
Weight (gr/m)	15	20	35	55	70	105	160	215	330

Standard compound	<b>white polyurethane thermoplastic 92 ShA</b>
Standard back cover	<b>none</b>
Standard tooth cover	<b>none</b>
Standard cords	<b>S and Z torsion zinked steel</b>
Standard width tolerance	<b>+/- 0,5 mm</b>
Standard thickness	<b>2,2 +/- 0,15 mm</b>
Standard thickness with NFT-NFB	<b>2,4 +/- 0,15 mm*</b>
Standard length tolerance	<b>+/- 0,8 mm/m</b>
Standard roll length	<b>100 m</b>

**Nylon fabric back**  
**Nylon fabric teeth**  
**Antistatic nylon fabric**  
**Transparent FDA compound**  
**AVAFC 60/70/85 ShA**  
**APL**  
**Fishbone**  
**Ribbed**  
**Cleats**

Belt options on request with a minimum quantity

TOOTH PROFILE ACCORDING TO ISO 17396

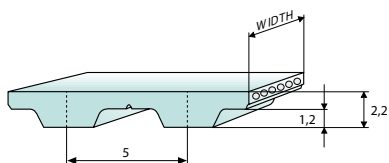

For different back coating materials see page 134

### TOOTH RESISTANCE

RPM (1/min)	0	20	40	60	80	100	200	300	400	500	750	1000	1500	2000	3000	4000	5000	8000
F <sub>p spec</sub> (N/cm)	24	23	23	22	22	22	20	19	19	18	17	16	15	14	12	11	11	9

Minimum suggested number of teeth in clamp for linear movement: 7

### TRACTION RESISTANCE

CORD MATERIAL	BELT WIDTH (mm)	6	10	16	25	32	50	75	100	150
Steel	Max Traction Load (N)	185	375	500	840	1060	1750	2400	3220	3640
	Breaking Strength (N)	750	1500	2000	3375	4250	7000	9125	12250	12750
	Elongation at MTL (mm/m)	4	4	4	4	4	4	4	4	4
Kevlar®	Max Traction Load (N)	490	985	1315	2225	2800	4615	6335	8505	9610
	Breaking Strength (N)	1975	3955	5275	8900	11210	18465	24075	32320	33635
	Elongation at MTL (mm/m)	8	8	8	8	8	8	8	8	8
HP	Max Traction Load (N)	–	585	780	1315	1655	2730	3745	5025	–
	Breaking Strength (N)	–	2340	3120	5265	6630	10920	14235	19110	–
	Elongation at MTL (mm/m)	–	4	4	4	4	4	4	4	–
HF	Max Traction Load (N)	–	490	655	1105	1390	2295	3150	4225	–
	Breaking Strength (N)	–	1965	2620	4425	5575	9180	11970	16070	–
	Elongation at MTL (mm/m)	–	5	5	5	5	5	5	5	–
Stainless	Max Traction Load (N)	155	305	410	695	–	–	–	–	–
	Breaking Strength (N)	615	1235	1645	2780	–	–	–	–	–
	Elongation at MTL (mm/m)	3,8	3,8	3,8	3,8	–	–	–	–	–

Average values

MEGALINEAR



# MEGALINEAR

## T5 OPEN-ENDED

### FLEXION RESISTANCE

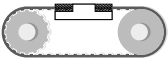
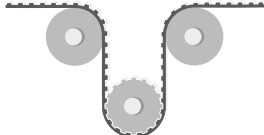
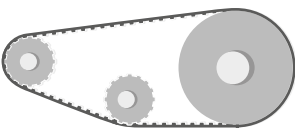
			
	$Z_{MIN}$	$Z_{MIN}$ IDLER MIN DIA (mm)	$Z_{MIN}$ IDLER MIN DIA (mm)
Standard steel cords	10	15 30	10 30
Kevlar® cords	12	15 30	12 30
High Power cords	15	15 40	15 60
High Flexibility cords	10	12 30	10 30
Stainless steel cords	15	18 40	15 40

### JOINED BELT INFORMATION:

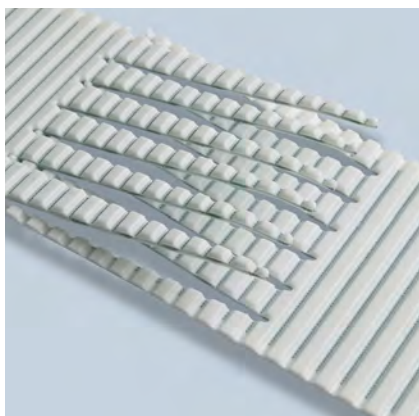

- Minimum splice length 900 mm
- Traction and tooth resistance = 50% less than open-ended
- Joined belt can be used only in conveyor systems
- Rolls with NFT, NFB, AVAFC, and APL can be joined too
- Minimum diameters according above table
- For coated belts, minimum diameters on page 134

### PULLEYS

(FOR MORE DETAILS, PLEASE SEE OUR PULLEYS CATALOGUE)

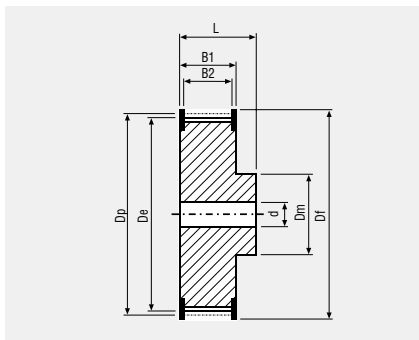

N° TEETH	DP	DE
10	15,92	15,09
12	19,10	18,27
14	22,28	21,45
15	23,87	23,04
16	25,46	24,64
18	28,65	27,82
19	30,24	29,41
20	31,83	31,00
22	35,01	34,19
24	38,20	37,37

N° TEETH	DP	DE
25	39,79	38,96
28	44,56	43,73
30	47,75	46,92
32	50,93	50,10
36	57,30	56,47
40	63,66	62,93
42	66,85	66,02
44	70,03	69,20
48	76,39	75,57
60	95,49	94,67